



DIN FLANGE DIN 2634

WELDING NECK FLANGE

4). Nominal Pressure 25

The flanges with the dimensions of this standard and made of St. 37-2 can be used at maximum 120 °C temperature with up to 25 kg/cm² of working pressure. At higher temperature- from 120 °C to 300 °C , it should be taken into consideration that the material yield point becomes low.

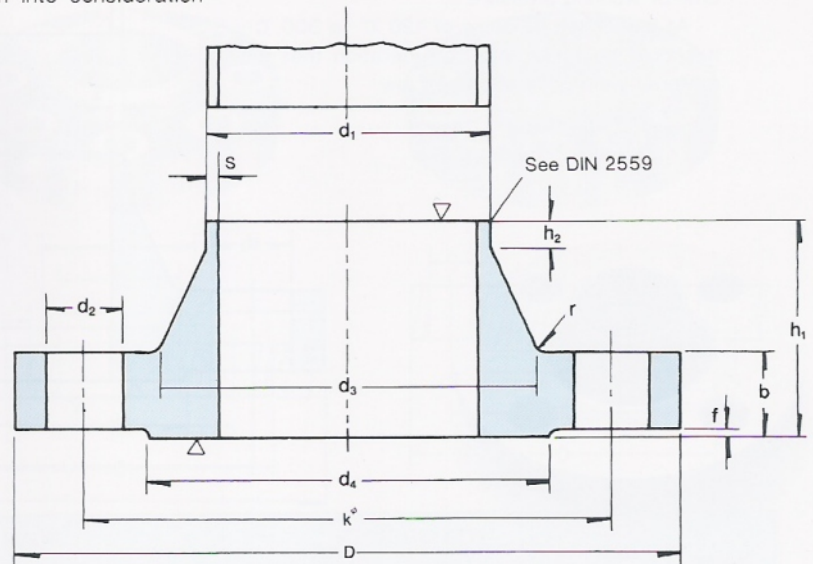
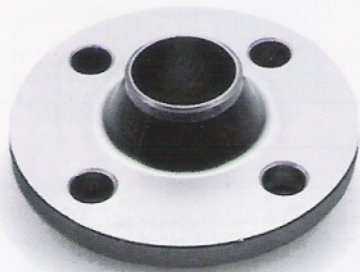

(Dimensions in mm)

| Nominal Pressure 25 | | | | | | | | | | | | | | | | |
|---------------------|-----------------|--------|----|------|----------------|----------------|------|----|----------------|----------------|---|-----------------|---------------|----------------|--|--|
| Pipe | | Flange | | | | Neck | | | | Raised Face | | Drilling | | | Approx. Weight (7.85 kg/dm ³) kg | |
| Nominal Size | d ₁ | D | b | k | h ₁ | d ₃ | s | r | h ₂ | d ₄ | f | Number of Holes | Bolt Diameter | d ₂ | | |
| (175) | (191 193.7*) | 330 | 28 | 280 | 75 | 215 218 | 5.6 | 10 | 15 | 248 | 3 | 12 | M24 (7/8") | 27 | 13.4 | |
| 200 | 216 219.1*) | 360 | 30 | 310 | 80 | 240 244 | 6.3 | 10 | 16 | 278 | 3 | 12 | M24 (7/8") | 27 | 17.0 | |
| 250 | 267 273*) | 425 | 32 | 370 | 88 | 292 298 | 7.1 | 12 | 18 | 335 | 3 | 12 | M27 (1") | 30 | 24.4 | |
| 300 | 318 323.9*) | 485 | 34 | 430 | 92 | 345 352 | 8 | 12 | 18 | 395 | 4 | 16 | M27 (1") | 30 | 31.2 | |
| 350 | 368 355.6*) | 555 | 38 | 490 | 100 | 398 | 8 | 12 | 20 | 450 | 4 | 16 | M30 (1 1/8") | 33 | 45.0 | |
| 400 | 419 406.4*) | 620 | 40 | 550 | 110 | 452 | 8.8 | 12 | 20 | 505 | 4 | 16 | M33 (1 1/4") | 36 | 58.7 | |
| 500 | 521 508*) | 730 | 44 | 660 | 125 | 558 | 10 | 12 | 20 | 615 | 4 | 20 | M33 (1 1/4") | 36 | 86.1 | |
| 600 | 622 609.6*) | 845 | 46 | 770 | 125 | 660 | 11 | 12 | 20 | 720 | 5 | 20 | M36 (1 3/8") | 39 | 101 | |
| 700 | 720 711.2*) | 960 | 46 | 875 | 125 | 760 | 12.5 | 12 | 20 | 820 | 5 | 24 | M39 (1 1/2") | 42 | 134 | |
| 800 | 820 812.8*) | 1085 | 50 | 990 | 135 | 865 | 14.2 | 12 | 22 | 930 | 5 | 24 | M45 (1 3/4") | 48 | 183 | |
| 900 | 920 914.4*) | 1185 | 54 | 1090 | 145 | 968 | 16 | 12 | 24 | 1030 | 5 | 28 | M45 (1 3/4") | 48 | 232 | |
| 1000 | 1020 1016*) | 1320 | 58 | 1210 | 155 | 1070 | 17.5 | 16 | 24 | 1140 | 5 | 28 | M52 (2") | 56 | 302 | |

Refer to DIN 2635 for nominal size 10-150.

Size in parentheses should preferably be avoided.

*) Outer diameter of pipe corresponds to ISO recommendation R64.

Material (to be specified by orderer):

St.37-2 by DIN 17100 for temperature ≤ 300 °C .

Weldable heat-treated steel for temperature > 300 °C .

Process : Machining the outside diameter, bore, gasket surface, bevel end for welding, and bolt holes.